

# SITE PLAN NOTES

1. PROTECT ALL EXISTING TREES DURING CONSTRUCTION
- Proposed electrical facility to feed the new service. intent is to have burried service from the power pole to the building

Please add a note stating, "Where electric facilities are installed, BTU has the right to install, operate, relocate, construct, reconstruct, add to, maintain, inspect, patrol, enlarge, repair, remove and replace said facilities upon, over, under, and across the property included in the PUE, and the right of ingress and egress on property adjacent to the PUE to access electric facilities."

There are no plans to have cable/telephone to the building

## LEGEND

SYMBOL	NAME	SF	COUNT	TOTAL
	CREPE MYRTLE	150	2	300
	EXISTING CANOPY TREE LARGER THAN 4.5" DIA.	400	4	1600

TOTAL SF PROVIDED 1900  
 TOTAL SF REQUIRED: 1788  
 15% OF 11,924

Owner:  
 Foster Stained Glass LLC  
 2801 S. College Ave.  
 Bryan, TX 77801

.2732 acres  
 11,900 sqft total lot size

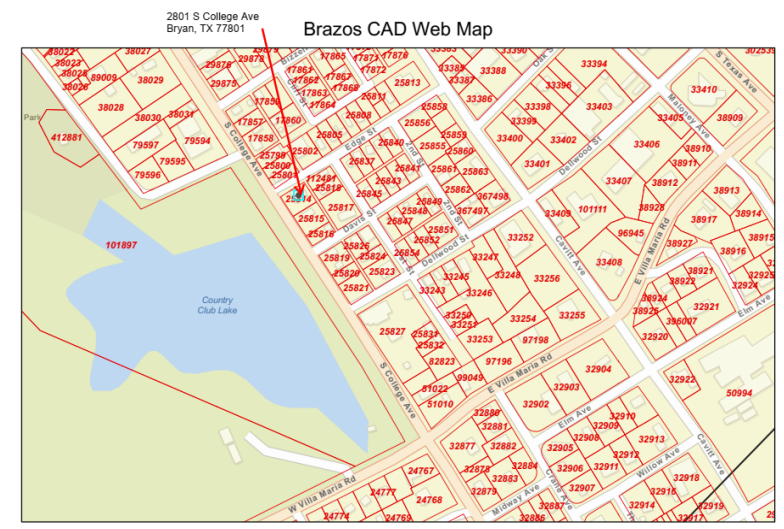

Scale  
**SITE PLAN**  
 1/16" = 1'-0"

# SOUTH COLLEGE AVE